



Coriolis® COMPACT



Portable Dry Cyclonic Air Sampler

- Innovative technology compatible with any downstream analysis
- Adapted for indoor and outdoor collection
- Light & compact for mobile applications

Coriolis® COMPACT



Portable dry air sampler

The Coriolis Compact® is a dry cyclonic collector intended for air monitoring. Light and compact, it can be easily transported and positioned on strategic places for **indoor and outdoor sampling**. Its **innovative dry cyclonic technology** aspirates the particles with an airflow of 50L/m and makes them travel through the collection cone where they are retained. The collected particles or microorganisms can then be recovered by rinsing consumable with appropriate buffer solution, so **the sample is compatible with multiple downstream analysis** (NGS, qPCR, Culture).

The Coriolis® Compact gives access to **highly sensitive and specific results in only a few hours**. Due to an improved battery autonomy, it performs up to **8 hours of continuous sampling**. Bertin provides **single use consumable** to avoid cross contamination.

Applications:



Pollution & Environment



Food / Pharma / Veterinary / Industry



Biomedical & Health



Research & Development

Innovative dry cyclonic technology:

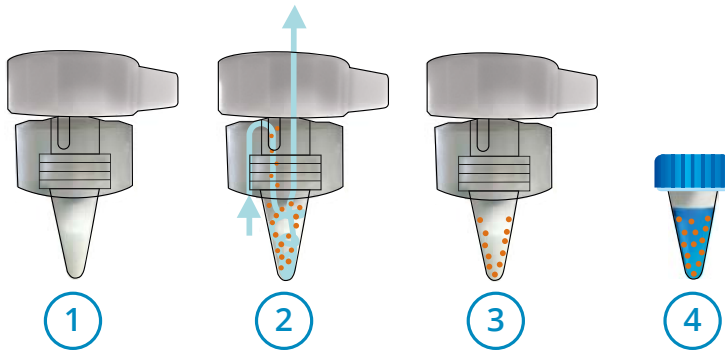

1. The cone is placed on the device and locked
2. Aspirated air runs into the cone
3. Particles contained in the air are retained on the cone wall
4. Collected particles are recovered by adding liquid in the cone

Bertin's Life Sciences Solutions

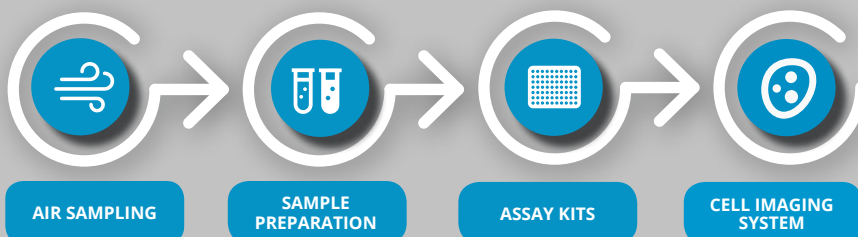

Technical features

DIMENSIONS
255x135x130 mm

WEIGHT
1,2 kg

TEMPERATURE RANGE
+5°C to +45°C
with a humidity range of 10% to 90%

FLOW
50 L/min

SIZE OF PARTICLES COLLECTED
From 500 nm to 10 µm

TYPE OF PARTICLES COLLECTED
bacteria, viruses, molds...

AUTONOMY ON BATTERY
8 hours in operation

TECHNOLOGY
Dry collection